



**All Breed AHBA Herding
Trials & Tests**
**Sponsored by Del-Bay
Herding Club**

Scarlets
Mill Farm,
2384 Hay
Creek Rd.
Birdsboro,
PA

Saturday & Sunday June 15 & 16 2024

CLASSES OFFERED:

Both days:

HRD Cattle(limit 8 runs/day), HTD ducks,
HTAD ducks (Course #2), HTAD sheep (Course #2)
JHD (sheep), HCT (sheep)

STOCK

Sheep: Mixed Wool & Hair Breeds – 5 sheep per run (Value: \$250 per head)
Ducks: Bantams (i.e., Call Ducks) – 5 ducks per run (Value: \$45 per head)
Cattle: Dexter, Lowline Angus -5 cattle per run (Value: \$850 per head)

JUDGES:

Karen Trimble & Kelly Hughes

Entry limit: 40 runs/judge/day

Entry fees: \$65 sheep & ducks, \$85 cattle

AWARDS

Qualifying Runs: Green Q Ribbon

1st – 4th Place: Ribbons

High in Trial for Each Day

For Information & entries:

BD White, 1700 Joe Goldsborough Rd., Smyrna DE 19977

delbayherding@gmail.com

PreEntries close: June 5

Day of entries add \$10

No refunds

Outdoors - Rain or shine These trials held under the rules of the American Herding Breeds Association

AHBA RULES: All rules can be found on their website <http://www.ahba-herding.org>

DIRECTIONS – PLEASE READ!

From I-78/I-80/Allentown: DUE TO RT 82 CLOSED SOUTH OF BIRDSBORO, THESE ARE ALTERNATE DIRECTIONS.

Follow Rt 100 South to Rt 23. Turn right onto Rt 23 (Ridge Rd) and go to Elverson. Turn right onto Rt 82 (N Chestnut St/Elverson Rd). When you get to a 4 way stop, follow Rt 82 to the right. From there, go 4.8 miles through Geigertown (Fire Station on the right) to the stop sign. Turn LEFT at the stop sign. You have arrived at the trial site on the left after the turn (two stone pillars at entrance of drive). Please use second driveway on left (Rock Hollow Rd) for parking.

From the PA Turnpike exit 298:

Take Route 10 North/Beckersville 0.6 miles, then turn RIGHT onto Joanna Rd. Go 0.9 miles to stop sign (at Joanna Store) and turn RIGHT. Go 0.4 miles to the stop sign and turn LEFT onto Route 82 North (Hay Creek Road/Twin Valley Rd). Go 4.8 miles through Geigertown (Fire Station on the right) to the stop sign. Turn LEFT at the stop sign. You have arrived at the trial site on the left after the turn (two stone pillars at entrance of drive). Please use second driveway on left (Rock Hollow Rd) for parking.

From Philadelphia Intl Airport to Morgantown:

Merge onto I-95 S toward Delaware. Exit onto I-476 N (exit 7) toward Plymouth Meeting. Exit onto I-76 W (exit 16B) toward Valley Forge. Take Exit 298 (I-176, Rt 10, Morgantown/Reading). Follow directions above.

From NY/NJ/East:

NJ Turnpike to exit 6 (PA Turnpike W). Merge onto NJ Turnpike Ext. NJ Turnpike Ext. becomes PA Turnpike W (I-76). Take Exit 298 (I-176, Rt 10, Morgantown/Reading). Follow directions above.

From Points West: Take I-76 (PA Turnpike) East. Take Exit 298 (I-176, Rt 10, Morgantown/Reading). Follow directions above.

HRD Course Map

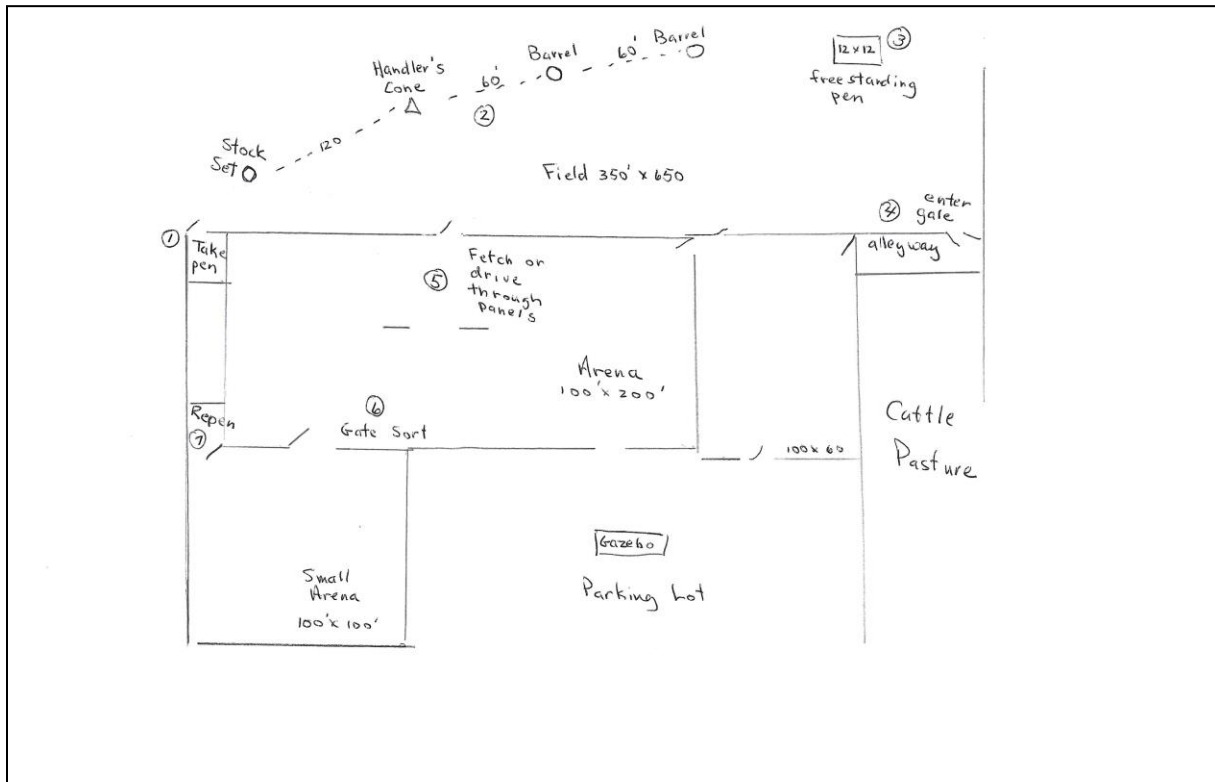

HRD Cattle Course Description June 15 & 16 2024

1. All Levels – Take Pen and set stock on feed pan

2. Place dog at Handler's Cone
HRDI – fetch or drive to 60' barrel
HRDII – drive from handler's cone to 60' barrel
HRDIII – drive from handler's cone to second barrel (120')

3. Free Standing Pen
HRDIII only (10 points)

4. Alleyway Gate – all levels enter here and take stock into arena

5. Cross Drive Panels
HRDI – fetch or drive through panels
HRDII & III – drive through panels

6. Gate Sort Into Small Arena
HRDI – sort any one cow
HRDII – sort any 2 cows
HRDIII – sort 3 marked cows

7. Repen
All levels must do a hold before repen
All levels must repen all stock

Entry Form: AMERICAN HERDING BREED ASSOCIATION SANCTIONED TEST/TRIAL

Dates: June 15 & 16 Sponsor: Del Bay Herding Club Location: Scarlets Mill Farm, Birdsboro PA
 Entry fees & address of secretary: See page one

MULTIPLE DAYS ENTRIES CAN BE SHOWN ON ONE FORM

Dog's Call Name: _____ Dog's Registered Name: _____

Breed: _____ Sex: _____ Registry #: _____

Sire: _____ Dam: _____

Birthdate: _____ Breeder: _____

Name of Owner: _____ Phone #: _____

Address: _____

Email address: _____ Handler: _____

Day:	Stock:	Class:	Fee:	Day:	Stock:	Class:	Fee:
Day:	Stock:	Class:	Fee:	Day:	Stock:	Class:	Fee:
Day:	Stock:	Class:	Fee:	Day:	Stock:	Class:	Fee:
Day:	Stock:	Class:	Fee:	Day:	Stock:	Class:	Fee:
Total Fees Enclosed:							

AGREEMENT TO HOLD HARMLESS, WAIVER AND ASSUMPTION OR RISK: In consideration for participation in an event sanctioned by the American Herding Breed Association (AHBA), I agree to assume all responsibility for any claim, loss or damage, of whatever kind or nature, whether to person or property, which may be caused at or near this event, either directly or indirectly, by me or the dog or dogs I have entered in or brought to this event. I agree to indemnify the AHBA, DBHC, their officers, directors, agents and members, and/or Scarlets Mill Farm, for any loss, cost or expense including attorneys fees and costs, to which they might be subject as a result of any claim, suit, loss or damage caused in any way by any act or negligence on my part or on the part of any dog or dogs I have entered in or brought to this event. I acknowledge that while the AHBA may provide sanctioning for this event with regard to the issuing of titles, it does not have and does not exercise control over the conduct of the event or those present. I certify and represent that the dog or dogs I have entered in or brought to this event is/are not a hazard to other dogs, other animals, or to people. I further agree that I will hold the AHBA, the Del Bay Herding Club, their officers, directors, agents and members, and/or Scarlets Mill Farm harmless and defend them from any and all liability for any injury, claim, damage or loss, of whatever kind or nature, whether to person or property, caused at or near this event, whether directly or indirectly, by me or any dog I have entered in or brought to this event. I assume full responsibility and liability of the dogs I enter and certify that they are current on all vaccinations. I also agree to be responsible for paying the market value for any animal mortally injured by my dogs and for any vet bills incurred on any animals injured by my dogs(s). I understand that attendance at this event is not without risk to myself or my dog(s) because some of the dogs and livestock to which I will be exposed may be difficult to control and may be the cause of injury even when handled with the greatest amount of care

Signature of owner/authorized agent: _____ Date: _____